

SUMMARY

Deeded Name	DEWAINE M DODDS & KRISTINA L DODDS		Taxpayer	DODDS DEWAINE M & KRISTINA L	
Owner	DEWAINE M DODDS & KRISTINA L DODDSS 611 SE 20TH PL CAPE CORAL FL 33990-2762			611 SE 20TH PL CAPE CORAL FL 33990-2762	
Tax District	52-WASH RUSS PT CORP		Land Use	1-LIKE REAL	
School District	INDIAN LAKE S D		Park	HOLIDAY HARBOR	
Neighborhood	03200-INDLKWFL		CD Year		
Location	246 ORCHARD ISLAND RD LOT 52 RUSSELLS POINT OH 43348				
Date Sited	6/3/1992	Date Acquired	10/11/2022	Home Make	NEW YORKER
Home Model	52X24	Home Serial Number	52X24NYD314	Home Title Number	7500590041
Home Year	1978	Sold	09/13/2022	Sales Amount	97,500.00

VALUE

District	52-WASH RUSS PT CORP	
Land Use	1-LIKE REAL	

	Appraised	Assessed
Improvement	11,560	4,050
Homestead	N 0	0
OOC	N 0	0
Taxable	11,560	4,050

CURRENT CHARGES

Full Rate	73.600000			
Effective Rate	47.693448			
Qualifying Rate	39.345614			

	Prior	First	Second	Total
Tax	0.00	88.62	88.62	177.24
Special	0.00	0.00	0.00	0.00
Penalty	0.00	8.86	0.00	8.86
Total	0.00	97.48	88.62	186.10
Paid	0.00	0.00	0.00	0.00
Due	0.00	97.48	88.62	186.10

TRANSFER HISTORY

Date	Conveyance	Deed Type	Sales Amount	Valid
09/13/2022	Buyer: DODDS DEWAINE M & KRISTINA L Seller: REEL MARCIA A	209 Title	\$97,500.00	Y
07/07/2021	Buyer: REEL MARCIA A Seller: GRIFFITH RONALD R & KATHERINE	114 Title	\$90,500.00	Y

DWELLING

Style	1-CONVENTIONAL	Family Rooms	0	Heating	Y
Stories	1.00	Dining Rooms	0	Cooling	Y
Rec Room Area	0	Year Built	1978	Grade	D-1
Finished Basement	0	Year Remodeled		Fireplace Openings	0
Rooms	6	Full Baths	2	Fireplace Stacks	0
Bed Rooms	3	Half Baths	0	Living Area	1,608
		Other Fixtures	0	Total Area	1,608
				Value	11,440

OTHER IMPROVEMENT

Type	Year Built	Year Remodeled	Condition	Dimensions	Description	Size	Value
07-CARPORT	2000		A-AVERAGE	18 X 20	Length x Width (Optional)	360	120
						Total	120

SKETCH

ID	Description	Size	Floor	Floor Area (ft ²)	Living Area (ft ²)
A	1SFR (1 STORY FRAME)	1,248	First Floor	1,608	1,608
B	WDDK	192	Total	1,608	1,608
C	OP	96			
D	1SFR (1 STORY FRAME)	360			
1	07-CARPORT	360			

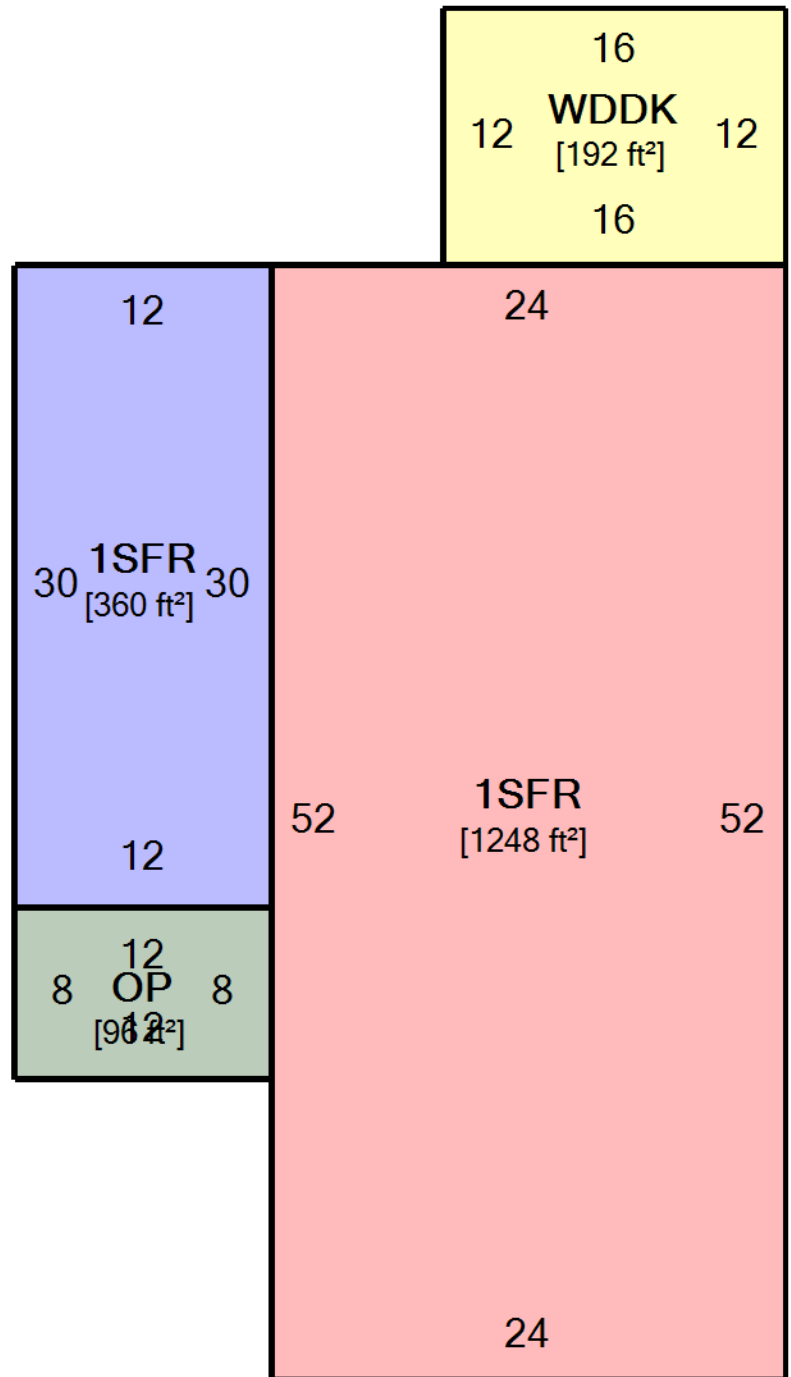

1